



Showfish

JAN-FEB 2006

NEWSLETTER OF THE COAST FISH CLUB

VOLUME 15, ISSUE 1 & 2*

What's Inside —

- 2 [Membership News](#) — New members, memberships due and past due
- 3 [Board of Directors](#)
Dates of 2006 meetings
- 4 **Sponsors** — A partial list of supporting manufacturers who contribute goods to our club
Old News about Sponsors
Synopsis of January meeting
MEETING TIMETABLE —
Meeting actually begins at 1:00,
Speaker starts at 1:15
- 5 **Events Elsewhere** — San Diego fish club have field trip of LA and Orange Cty fish stores soon
- 7 **Where We Meet**
For Sale Item
Flow-through In-Tank Hatchery
- 8 **Plants for the Temperate Fish Aquarium**
COAST Discussion Group

The Showfish is published monthly by California's Organization of Aquatic Show Tropicals.

Edited by Charlotte Marelius

Printing and distribution are by McCabe Printing of Norwalk CA.

Unless marked with a © symbol, articles, photos and/or artwork may be reprinted by other societies, providing full credit is given to the author and/or artist, COAST, and to the Showfish. A copy of the publication containing the reprinted material should be sent to the editor upon publication.

Opinions, conclusions, and attitudes expressed herein are those of the authors and do not necessarily represent those of COAST fish club. COAST is not responsible for information or actions taken based on information presented in the Showfish or at club meetings.

Items for publication in Showfish are due within one week after the monthly meeting and will be included as space and time permit within constraints of club bylaws. Articles received after the deadline will be used in the next newsletter as permitted.

Editorial Team: Charlotte Marelius, Mike and Elaine McCabe

February 12th Meeting — Mark Binkley Topic: Native North American Fishes

Mark, who had to reschedule his presentation from November to February, is an active member of the North American Native Fish Association, which works with Canadian, American and Mexican fish. He runs an online native fish store out of Thousand Oaks, CA. Those who attended Findig 2004 may have heard him speak there.

He hopes to be able to bring a few native fish to sell as well, but availability is unknown at this time. To see some of the fish and equipment he has for sale, see/contact Jonah's Aquarium, Thousand Oaks, CA 91359, Toll Free 877-417-4871, Phone 330-347-9275, website <http://www.jonahsaquarium.com> 

Website News — We're getting a new one!!

Check out our preliminary new website! Over the next few months, Rahul Kumar and Tom Varin will be creating a new website for the club, <http://www.coastfishclub.com>. It will be a lot more interesting and functional than the existing website, which provides only meeting announcements and auction/membership forms.

The new website has a completely new look and an attractive, user-friendly layout with easy-to-read text and good display size, even on a laptop. Initial features planned are member access to current and past Showfish and to the current members' roster, and auction forms and bag labels we can fill in on the computer. Possible features being investigated are member email addresses, photo galleries, and online membership application/renewal (dependant on cost of processing credit cards/fund transfers).

It is now up for public comment and suggestions; examine the content, the layout, how well everything works; give Rahul feedback. 

The End of a Florida Fish Farm

By Brian Downing

A couple of months ago, shortly after the hurricanes in Florida, I was in Fort Lauderdale on business. I made arrangements to stay an extra day to visit a friend who lived close by with the hopes that we could visit a Florida fish farm. I didn't expect to find that all the rental cars would be booked up. I ended up on the local train system to West Palm Beach. Twenty miles and two and a half hours later I got to my destination.

After a good breakfast we headed off to a local fish farm. It turned out that the owner had recently passed away and the farm was to be sold to a developer. There was one worker there that was given the

job of closing up the farm. As we entered the farm there were several rows of concrete vats, about six feet wide and fifteen feet long.



Empty concrete vats



Birdnetting over vats of swordtails

They were full of colorful swordtails, ready to be sold. The vats were covered by a plastic mesh designed to keep out birds. Apparently they get several types of predators eating the fish: snakes, turtles, otters and birds. Other vats held long finned plecostomus. The swordtails and plecostomus were bred and grown out in the vats. Caves were provided in each of the plecostomus vats for breeding. Each one has a large male sticking out of the entrance. What surprised me was that they provided palm branches in each plecostomus vat for the fish to hide in, which they did in large numbers. Water was supplied to each vat continuously, pumped from wells and overflowed out drains from the vats.

The farm was overgrown with tall grass everywhere, making the ponds hard to find. The first pond we came to was huge. It had to be twenty or more feet wide and over a hundred feet long. The first question I had was how would it be possible to seine out the fish? The

Membership News —

In Memorium



AJ Sprague passed away at the beginning of January this year.

AJ joined the club in September 2004 with Barbara Healy-Sprague.

New/Returning Members

The following people joined COAST recently - Welcome and Thanks!

- Terry Hemment, Norwalk
- Charles Clifford, Oceanside
- Len Liebrand, Tustin
- Suman Kapil
- John Banic
- Sham Kapil, Van Nuys
- Kam Bhogal, Saugus

Renewals Received

The following people have renewed their memberships—Thank You!

- Karen Peyser
- Lawrence Leshinski,
- Craig David
- Mike McCabe
- Alan Rosen
- Vin Kutty
- Paul, Virginia Emgen
- Donald Foltz

Member Renewals Due in February

Please remember to renew your membership this month.

- John Fuqua
- Ron Harlan
- Janice Hazeltine
- Rick, Charlotte Marelius
- Christina Marvel
- Ron and Mamie Nash
- Jim Tello
- Richard Woon
- Kenaan Tabikh
- Tom Varin

(continued on page 3)

Board of Directors

President:

Brian Downing..... 858-759-4841
brianjdowning@msn.com



Vice President

Vacant..... Phone TBD

Treasurer

John Skocilic TBA
jskoc@yahoo.com



Recording Secretary

Ron Nash TBA
coast@ronaldvnash.com

PHOTO OF
RON NASH
COMING SOON

Corresponding Secretary

Mamie Nash..... TBA

PHOTO OF
MAMIE NASH
COMING SOON

(continued on page 6)

(End of a Florida Fish Farm, cont.)

sides were overgrown with trees and weeds. Apparently when they built the ponds on this farm they built them too large.



Fish are caught by traps (see picture) that are fairly small (less than two feet long and six inches wide). Apparently they were sufficient for the job. As we went through the farm the ponds got even bigger! Reeds were growing in some.



At the other side of the farm was their packing facility. It was full of tanks packed with fish ready to ship: plecostomus, swordtails, silver dollars, jack dempsseys. Boxes and bags were *(cont on sht 5)*

COAST MEETING DATES FOR 2006

<u>DATE</u>	<u>SPEAKER</u>	<u>TOPIC</u>
February 5.....	Mark Binkley	Native North American Fishes
March 5	TBA	
April 2.....	TBA	
May 7.....	TBA	
June 4.....	TBA	
July 2	TBA	

(Speakers and topics will be announced as they confirm.)

OUR SPONSORS – Manufacturers Who Support Our Club

When making buying decisions, please assess these companies' products and remember the investment they make in the tropical fish hobby. They have all generously donated dry goods to our club for the raffle.

Marineland	Tropical Fish Hobbyist
Mardel Labs	Top Fin
Dainichi	Aquarium Pharmaceuticals
Hikari	Tetra
Kordon	Eheim
Brine Shrimp Direct	San Francisco Bay Brand
Barrons	

OLD NEWS ABOUT OUR SPONSORS— Marineland and Tetra now owned by Spectrum Brand, Inc.

Marineland, who owns Aquarium Systems, Perfecto Manufacturing, Jungle Talk, and Fin Club, was bought by Rayovac in January of 2005. Rayovac was subsequently bought by Spectrum Brands (makers of Spectracide, Cutter Insect Repellent, Remington shavers, and a variety of other lawn and garden products). Spectrum has also acquired Nature's Miracle, Dingo rawhide chews, 8inOne (Wild Harvest seed, Ecotriton, One Earth, Pet Habitat, Avison), and Tetra.

I did not see any press releases on plans for consolidation or facilities closures, but I'm sure a business case could be made for either or both scenarios. With the cost of doing business in California and the rise in property value here in the last year, Marineland would certainly be one of the most vulnerable to being moved elsewhere.

JANUARY MEETING SYNOPSIS –

There was a brief meeting of Board of Directors before the general meeting. John Skocilic announced to the Board of Directors that he was going to be unable to handle the treasurer's responsibilities for two to three months due to having to repair his back. Pauline Jackson will be handling treasurer's duties until John is recovered. She has updated the member chair now on those people who joined or renewed in October, November, and December.

Rahul Kumar has volunteered to create a new website and requested the purchase of a domain registration/hosting package. The board authorized the expenditure (Rahul and Tom Varin found an excellent package deal) and we now have a domain: <http://www.coastfishclub.com>. Rahul is creating the website structure and designing the look while Tom is preparing and uploading content. The website, in test condition, is up and open for comments.

The club now owns a digital projector, which broadens our speaker presentation media. Brian Downing is custodian of it for now.

The general meeting featured speaker Vin Kutty presenting his last collecting trip to Bolivia. He found some incredible fish and a great deal on a piece of land tucked up against the Brazilian border. The meeting concluded with the usual auction; there were several bags of fish species that we don't see too often, books, live foods, and driftwood, all going for good prices. Meeting adjourned about 4:00 or 4:30.



Showfish is not sent to people whose memberships have been expired more than one month.

Member Renewals Past Due

- ▶ Barbara Healy-Sprague - Sept
- ▶ Michael Booth -Oct
- ▶ Bryan Lampl - Oct
- ▶ Bonnie Lewis - Oct
- ▶ Machiel, Kathy Van Dam - Oct
- ▶ Sandy Binder - Nov
- ▶ Kevin Bruner – Dec
- ▶ Kevin Joseph - Dec
- ▶ Ed, Barbara Semanski - Dec
- ▶ Jason, Jennifer Kucera - Dec
- ▶ Pam Harris – Jan

▶ This symbol means this is your last Showfish until you renew.

Renewing members, please fill in a fresh membership application and mail it to the treasurer. Applications are on the last sheet of the newsletter. Membership number and due date are on the address label.

WHAT DOES THE CLUB DO WITH YOUR MEMBERSHIP DATA?

1. We notify you of upcoming meetings or changes via email.
2. Permitted data is listed in the club-only membership roster.
3. Sponsors often require member data before they will donate to the club. We give them a list limited to names and zip codes.
4. Contact info of board members sometimes shows on public documents or our club website.

MEETING TIMETABLE –

Meetings will adhere to the following timetable as closely as possible.

- 12:30 p.m. Board Meeting
- 1:00 p.m. Meeting starts
- 1:15 p.m. Speaker Presentation
- 2:30 p.m. Auction begins
- 5:00 p.m. Room must be vacated

Please arrive a bit early to get settled in time for the meeting.

Note: We are losing money on the food. Food and drink are not free; please fork over at least \$2 per person for food (waived if you bring food) and 50¢ for each soda.

Events elsewhere in the hobby –

February 13 - 16
Marine Ornamentals '06 and
Aquaculture America in Las
Vegas, NV.
<http://hawaiiacquaculture.org/marineornamentals06.html>

February 18
San Diego Fish Club is having a
**field trip of LA and Orange County
fish stores.** The club meets the second
Sunday of the month. For more
information see
<http://www.sandiegotropicalfish.com>

March 23 - 25
Global Pet Expo 2006 in San
Diego, CA
<http://globalpetexpo.org/>

April 28-30
American Livebearer Association
2006 Convention will be held at the
East Hanover, New Jersey Ramada
Hotel & Conference Center. The ALA
Convention is being held on the East
Coast for the first time in 35-years.
<http://livebearers.org/ALAPublic/Default.htm>

May 11 - 14
INTERZOO 2006 in Nuremberg,
Germany
<http://www.interzoo.com/main/ddkcmf/yw/ddqd0kgd/page.html>

July 19-23
American Cichlid Association
2006 Convention Arlington Heights
(suburb of Chicago)
<http://www.aca2006.com>

Desert Fish Club, a brand new
club in Palm Desert, meets the third
Sunday of the month in a local aquar-
ium store. For more information,
call Wanda Jacobson at 760-328-
8842.

(cont. from sht 3) lined up ready to receive the fish.



One of the rooms of the building contained many small tanks that were used at one time for breeding egg-layers. It was obvious that the farm had not been used to its potential for quite some time.



Many vats surrounded the packing facility, full of mollies, swordtails and long finned rosy barbs. Just outside the building there was a two foot opening in the ground revealing the drainage system for the vats and the packing house. It was full of hundreds of fish! The drains on the farms all lead to the local drainage ditches.

Looking around the farm I couldn't help but think that there would be no way for the worker to empty these ponds of fish before the bulldozers filled them in. My friend was more disappointed that the vats couldn't be moved to the fish farm he's planning on opening. We went to say good-bye to the worker on our way out. He was feeding fish in one of the ponds (why I don't know!). As the feed hit the water we could see walking catfish rise to the surface. At one point the water appeared to be boiling! I have to think that these huge walking catfish ate their share of tropical fish. Add one more predator to the list. (Cont. on sht 6)



The farm was very interesting. While overgrown and suffering from neglect, it was an insight into the workings of a fish farm as well as how easily ornamental fish are introduced into the local waterways. On some farms huge pumps are used to empty most of the pond to enable the seining of the fish. These pumps move thousands of gallons an hour as well as many finned inhabitants into the local ditches. Fish losses are looked at as incidental and a cost of doing business, so no effort is made to catch any fish escaping. As a hobbyist who strives not to lose any fish through death and objects to careless introduction of non-native species, it was a real eye-opener. I can't help but think that a weekend with a dipnet in the local drainage ditches would fill my fish room several times over!



air pump



Storm damaged shed.



Directors



Ron Tom

Ron Jackson 714-638-8445
katfishron@aol.com



Tom Varin TBA
tvarin@usa.net



Ron Scott

Ron Estrada Ph TBD
Email TBD

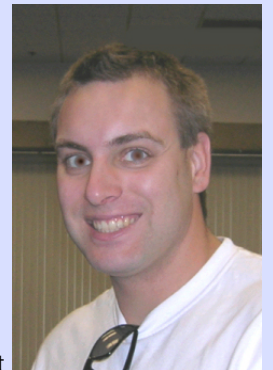

Scott Kroeger 949-701-0429

Program Chair Steve Ehrlich 310-398-4103
Hedabuvh20@aol.com



Steve Rahul

Website Administrator Rahul Kumar TBD
cichlidiot@gmail.com

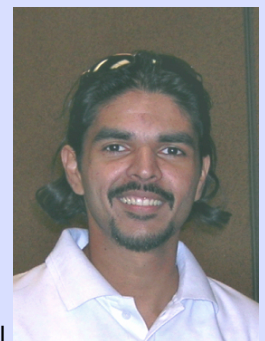

Membership Chair, Editor
Charlotte Marelius 818-360-7102
rcmarelius@earthlink.net



(continued on page 7)

Auctioneer

Duncan Mahoney....310-391-3704
dmahoney@usc.edu



Mike

Duncan

Printing and Distribution

Mike McCabe562-888-1992
mccabeprint@yahoo.com

Positions Needing A Warm Body

Refreshment Chair, Auction Clerk

COAST fish club meets the first Sunday of every month, in Costa Mesa from 1:00 to 5:00 p.m.

Costa Mesa Neighborhood Community Center,
Victoria Room
1845 Park Avenue,
Costa Mesa, CA 92627

For map, see the internet or Orange County Thomas Bros Guide pg 888 Zone J3.

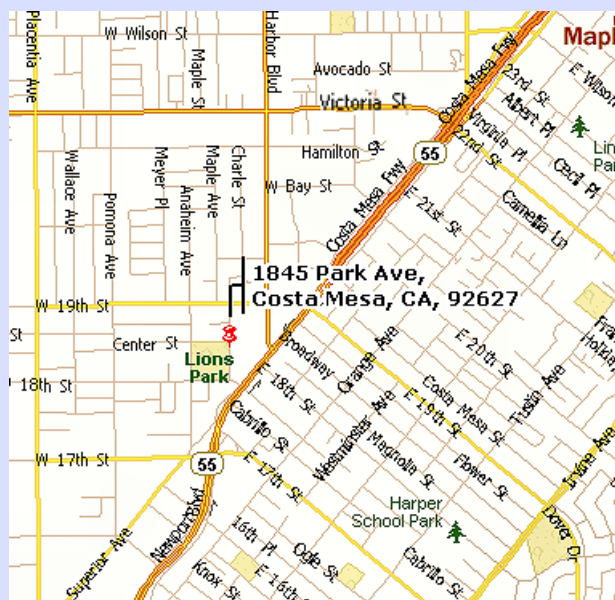

Scale: approx 1 mile

How much does your tank weigh?

- Glass: 2.713 grams/cm³ or 0.098 lbs/in³
- Lexan: 1.218 grams/cm³ or 0.044 lbs/in³
- Pine: 0.498 grams/cm³ or 0.018 lbs/in³
- Oak: 0.803 grams/cm³ or 0.029 lbs/in³

For example, a 200 gal glass tank with 7/16 thick glass weighs about 198 lbs [(72 X 24 X 24 X .437) X .098] while its pine cabinet stand weighs about 67 lbs, for a total of about 265 lbs empty. Freshwater weighs 7.75 lbs/gal (saltwater is 8.25 lbs/gal), then add 200 lbs gravel and 120 lbs of rock, for a without-fish-lights-or-canopy total of 2,135 lbs or 178 lbs/ft² of floor (exceeding the average floor design load by 28 lbs/ft², if memory serves). 🐟

FOR SALE:

50 gallon tank with oak stand and oak canopy – \$265
Contact Ron Jackson if interested. 714-638-8445

Constant flow-through in-tank hatchery

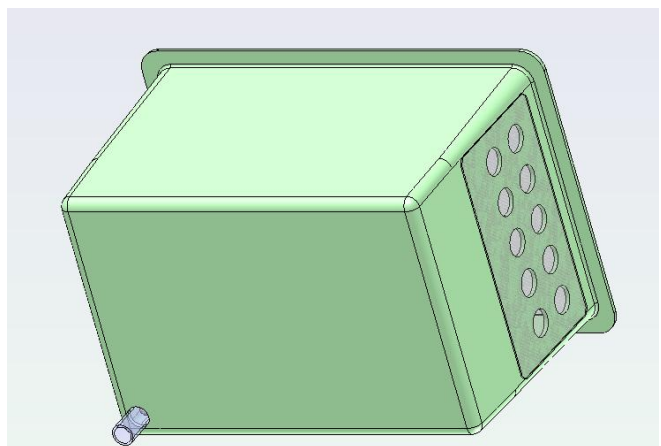
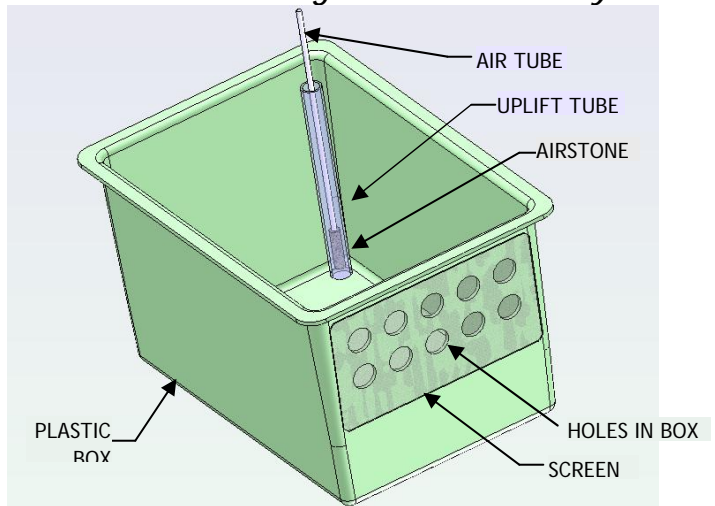

Glue tube (around, up the side) and screen to box w/RTV.

PLANTS FOR TEMPERATE FISH AQUARIUMS

PLANT	COMMON NAME	SUBSTRATE	LIGHTING	PH VALUE	HARDNESS	TEMP ° F
ACORUS GRAMINEUS	JAPANESE RUSH	PLAIN WASHED GRAVEL	NOT CRITICAL	6.8-7.5	NOT CRITICAL	59-70
ALTERNANTHERA ROSAEFOLIA	RED HYGROPHILA	PLAIN WASHED GRAVEL	VERY BRIGHT	NOT CRITICAL	NOT CRITICAL	64-68
APONOGETON BOIVINIANUS	NONE	FULL OF NUTRIENTS	NOT CRITICAL	7.5	NOT CRITICAL	64-77
APONOGETON MADAGASCARIENSIS	LACELEAF PLANT	PLAIN WASHED GRAVEL	MODERATE	NOT CRITICAL	NOT CRITICAL	59-77
ARMORACIA AQUATICA	AMERICAN CRESS	PLAIN WASHED GRAVEL	BRIGHT	NOT CRITICAL	NOT CRITICAL	64-77
BACOPA CAROLINIANA	GIANT RED BACOPA	PLAIN WASHED GRAVEL	NOT CRITICAL	6.8-7.2	10-15°	64-75
CABOMBA CAROLINIANA	GREEN CABOMBA	PLAIN WASHED GRAVEL	BRIGHT	NOT CRITICAL	NOT CRITICAL	55-77
CARDAMINE LYRATA	JAPANESE CRESS	PLAIN WASHED GRAVEL	BRIGHT	NOT CRITICAL	NOT CRITICAL	59-68
CERATOPHYLLUM SUBMERSUM	TROPICAL HORNWORT	NOT APPLICABLE	BRIGHT	NOT CRITICAL	NOT CRITICAL	50-82
CRINUM THAIANUM	ONION PLANT	PLAIN WASHED GRAVEL	NOT CRITICAL	NOT CRITICAL	NOT CRITICAL	64-81
DIDIPLIS DIANDRA	WATER HEDGE	PLAIN WASHED GRAVEL	SUBDUED	NOT CRITICAL	NOT CRITICAL	64-66
ECHINODORUS CORDIFOLIUS	RADICANS SWORD	RICH	BRIGHT	NOT CRITICAL	NOT CRITICAL	50-81
ECHINODORUS TENELLUS	PYGMY CHAIN SWORDPLANT	PLAIN WASHED GRAVEL	NOT CRITICAL	6.5-7.2	3-18°	59-79
EGERIA Densa	GIANT ELODEA	PLAIN WASHED GRAVEL	BRIGHT	7.0-8	20-25°	50-77
ELEOCHARIS ACICULARIS	DWARF HAIRGRASS	SOME CLAY OF BENEFIT	BRIGHT	NOT CRITICAL	NOT CRITICAL	50-77
HETERANTHERA ZOSTERIFLIA	WATER STARGRASS	RICH, SOME CLAY	BRIGHT	7.0-8	NOT CRITICAL	64-81
HYDROCOTYLE VULGARIS	PENNYWORT	FINE GRAVEL	BRIGHT	NOT CRITICAL	NOT CRITICAL	50-77
HYGROPHILA POLYSPERMA	DWARF HYGROPHILA	PLAIN WASHED GRAVEL	BRIGHT	NOT CRITICAL	NOT CRITICAL	59-86
LILAEOPSIS NOVAE-ZELANDIAE	NONE	RICH, SOME CLAY	BRIGHT	NOT CRITICAL	NOT CRITICAL	64-77
LUDWIGIA MULLERTII	RED LUDWIGIA	PLAIN WASHED GRAVEL	BRIGHT	NOT CRITICAL	NOT CRITICAL	57-79
MARSILEA CRENATA	DWARF FOUR-LEAF CLOVER	FINE GRAVEL	NOT CRITICAL	NOT CRITICAL	NOT CRITICAL	64-70
MYRIOPHYLLUM HIPPUROIDES	NONE	PLAIN WASHED GRAVEL	BRIGHT	NOT CRITICAL	NOT CRITICAL	59-77
NUPHAR JAPONICUM	JAPANESE SPATTERDOCK	RICH, SOME CLAY	BRIGHT	NOT CRITICAL	NOT CRITICAL	54-77
SAGITTARIA PLATYPHYLLA	GIANT SAGITTARIA	RICH	VERY BRIGHT	NOT CRITICAL	NOT CRITICAL	59-77
SAGITTARIA SUBULATA VAR SUBULATA	DWARF SAGITTARIA	OPEN TEXTURE GRAVEL	MODERATE	NOT CRITICAL	NOT CRITICAL	55-79
SALVINIA AURICULATA	BUTTERFLY FERN	NOT APPLICABLE	VERY BRIGHT	NOT CRITICAL	NOT CRITICAL	64-70
VALLISNERIA SPIRALIS	STRAIGHT VALLISNERIA	PLAIN WASHED GRAVEL	BRIGHT	NOT CRITICAL	NOT CRITICAL	59-86
VALLISNERIA TORTIFOLIA	TWISTED VALLISNERIA	PLAIN WASHED GRAVEL	BRIGHT	NOT CRITICAL	NOT CRITICAL	59-86

COAST Discussion Group for members only is growing on <http://groups.yahoo.com/group/coastfishclub/>

Have you joined the discussion group yet?

All you have to do is send an email requesting access to brianjdowning@msn.com and establish a yahoo identity by creating an email account with them (which you don't have to use).

The discussion group is a great place to:

- get questions answered
- discuss new DIY projects
- download the electronic version of the Showfish
- arrange to buy fish
- get last minute meeting announcements
- and chat with other members

Files section includes the Auction Registration form, bag labels, and the membership renewal form. A recent or current membership roster is also posted in the files. The **Photos** section includes pictures of DIY projects and people's tanks.

Traffic is pleasantly low, people are polite. Yahoo has excellent virus and spam filters, and a **huge email box** for you. (I have never gotten a virus as a result of being in a yahoo group or having a yahoo email account, even though I've been active on several groups for years.) **Check it out!**